

## Tool User Instructions

### 1 Initial Fitting

Push band fully into head

tabs

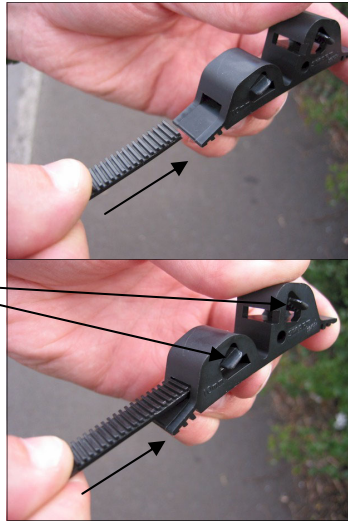

### 2 Applying

Wrap band around application & feed through head initially tighten by pulling on the band.

N.B. If it is likely that adjustment is needed be careful not to apply too much tension.



### 3 Adjusting

If the band requires adjustment release it by pulling the tabs away from the band and pushing the band back through the head.

N.B. This will only work before final tightening. If the band has been tightened fully then the tool will be needed to release.



### 4 Tightening

Once you are satisfied the band is in the right position use the tool for final tightening. This is done by threading the band through the tool & squeezing the handles until it is firmly tightened.

N.B. If band has been adjusted tabs may need to be pushed back down onto band to re-engage.



### 5 Cutting

To get rid of any excess band use the cutter on the tool.

N.B. If releasability is required, be sure to leave 50mm of band protruding to enable releasing.



Cutter

### 6 Releasing

To release using the tool. First thread the excess band into the tool & squeeze the handles. This will lift the tabs on the head.

Make sure tabs are fully released by pulling up with fingers and release the tool.

If tool is trapped onto band press the trigger to release.

Follow Step 3 for further adjustment.

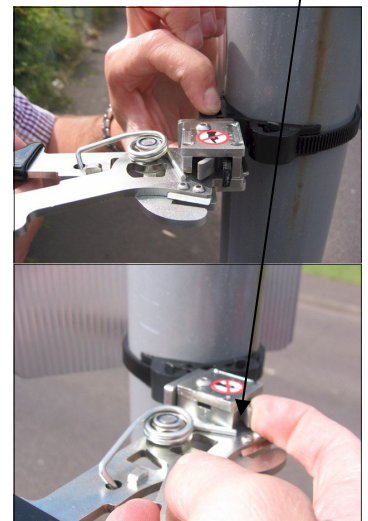

Trigger